

Equipped with an Agitator and a Spiral Pump Casing, Sand, Solids, Debris are Pumped with Minimal Wear and Clogging



Individual Features

Spiral Design

The large channel in the spiral casing allows sand and slit-laden water to pass through efficiently.

Air Lock Prevention

The shaft-mounted agitator prevents the "air lock" that tends to take place on semi-vortex or vortex pumps.

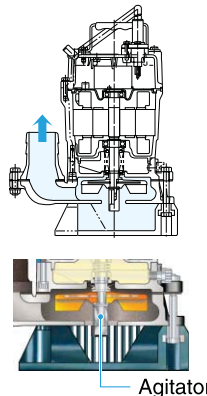

Simple Structure

The pump section can be disassembled and reassembled using a single 13-mm box wrench.

Auto Operation with Float Switch (HSZ)

The pump employs a float switch for automatic operation to prevent dry running and lower power consumption.



Major Standard Specifications

Discharge Bore	mm	50	80(50)	
Motor Output	kW	0.4 - 0.75		
Pumping Fluid	Type of Fluid	Rain, Spring, Ground, Sand Carrying Water		
	Fluid Temperature	0 to 40°C		
Pump	Structure	Impeller	Semi-vortex	
		Shaft Seal	Double Mechanical Seal (with Oil Lifter)	
		Bearing	Double-shielded Ball Bearing	
	Materials	Impeller	Urethane Rubber	
		Casing	Ductile Iron Casing	
		Outer Cover	Steel Plate	
Shaft Seal	Silicon Carbide			
Motor	Type, Pole	Dry Type Submersible Induction Motor, 2-pole		
	Class of Insulation	Class-E		
	Phase/Voltage	Single-phase/ 110V, 220V, 230V, 240V		
	Starting Method	Capacitor Run		
	Protection Device (Built-in)	Miniature Thermal Protector/ Circle Thermal Protector		
	Lubricant	Turbine Oil (ISO VG32)		
	Materials	Frame	Aluminium Alloy Casting	
		Shaft	403 Stainless Steel	
Cable		PVC		

Applications

Draining at civil engineering or building sites
 Draining storm water, groundwater, or puddles
 Draining from basements or utility pits

Standard Accessories

- Hose Coupling.....1pc
- Hose Band.....1pc

Performance Curves

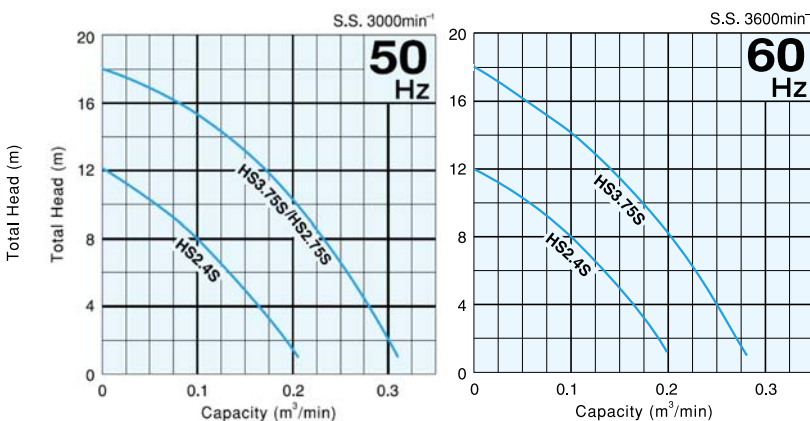

Dimensions

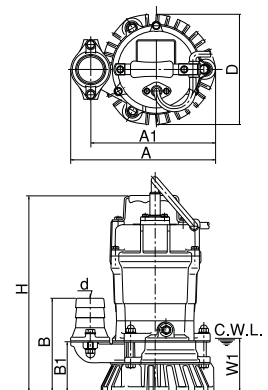

C.W.L. : Continuous Running Water Level

Standard Specifications 50/60Hz

Discharge Bore mm	Model	Motor Output kW	Phase	Starting Method	Dry Weight kgs	Cable Length m	Dimensions mm						C.W.L. mm	
							d	A	A1	B	B1	D		H
50	HS2.4S	0.4	Single	Capacitor Run	11.3	5	50	241	207	158	84	184	328	90
50(80)	HS2.75S	0.75	Single	Capacitor Run	17.5	5	80	285	233	217	109	184	388	90

● 80 mm discharge available on request ● Dry weight excluding cable